



WHY CHOOSE F.H.BRUNDLÉ?

- The largest stocks of expanded metal in the UK
- Mild steel, stainless & galvanised finishes
- Trade counter collections
- Cut to size service
- Free delivery on orders over £150

WHY SECURILATH?

As potential break-ins through doors and windows have been 'target-hardened' by grilles, shutters and alarms, would-be intruders have turned their attention to forced entry through walls, partitions, ceilings and roofs.

To counteract this, the Securilath system has been developed as a discreet method of significantly delaying the most determined intruder from creating an aperture large enough to gain entry to your client's premises.

Securilath can be installed at the time of construction into internal or external walls (solid or stud), ceilings and roofs, or can be retro-fitted whilst refurbishment is carried out. The option of finishing with dry lining or render is not lost with Securilath, as our range covers both options. Details of typical patterns are shown opposite.

TYPICAL SECURILATH APPLICATIONS

- Cash Handling Stores
- Control Rooms
- Firearm Stores
- Computer Rooms
- Remote Facility Security
- Wholesale & Retail Outlets
- Petrol Station Kiosks
- High Value Goods Stores
- Secure Units
- Pharmaceutical Stores

Although the typical focus is on protecting high value property, it makes sense to specify Securilath as a standard preventative measure in all security packages.

PRODUCT REF	APPLICATION	MATERIAL FINISH	PRODUCTION PROCESS	WEIGHT KG/M ²	STOCK SHEET SIZES (MM)
HD1	Heavyweight option for security in walls, partitions and ceilings	Mild Steel Galvanised Painted	3mm thick flattened mesh	8.59	2440 LW x 1220 SW
MD1	Lighter weight option for security in walls, partitions, ceilings and roofs	Mild Steel Galvanised Painted	1.2mm thick flattened mesh	1.85	2440 LW x 1220 SW 1220 LW x 2440 SW
HDR	For internal/external block walls. An excellent key for plaster/render finishes	Mild Steel Galvanised** Painted	3mm thick standard profile mesh, raised edge for rendering	6.52	2440 LW x 1220 SW

**Render & Plaster finishes should use galvanised Securilath

***Guidelines available upon request

SECURILATH HD1

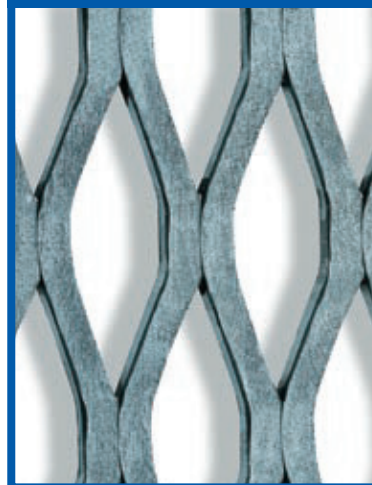

SECURILATH MD1

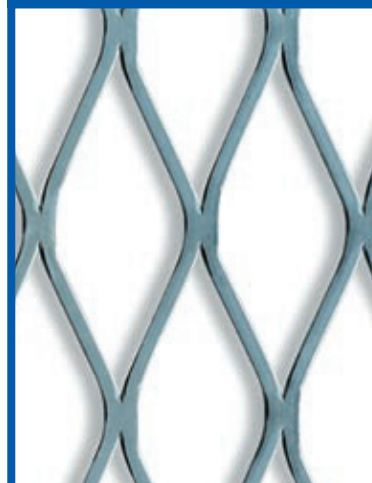

SECURILATH HDR

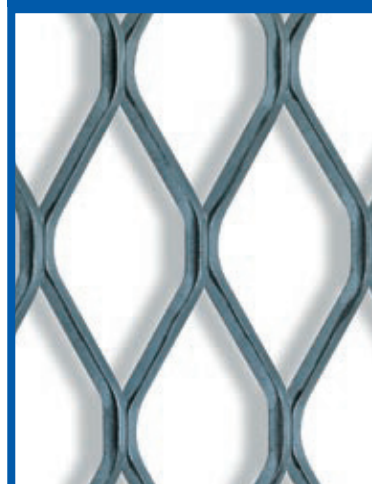

INSTALLATION, APPLICATION & FIXING DETAILS

Securilath is easily fixed to brickwork, blockwork, stud partitioning, ceiling joists and roofs in metal or timber. It is important to note that Securilath sheets should be butted together, and not overlapped. Suggested fixings for popular applications are shown below. For additional security we suggest reducing the spacing shown when Securilath is fixed adjacent to doors or windows.

► **TIMBER STUD WALLS AND CEILING JOISTS/RAFTERS**

Securilath fixed to stud with 30-38mm galvanised staples, 30-38mm galvanised screw nails or 65mm x 3.35mm bright annular nails (to BS1202) and min 25mm dia x 1.5mm galvanised washers fixed at maximum 450mm centres.

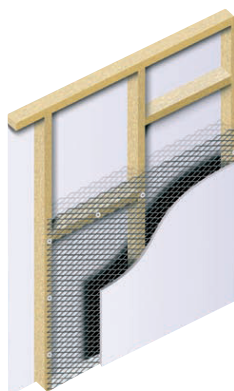

HD1&MD1

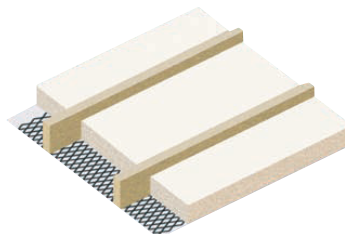

HD1&MD1

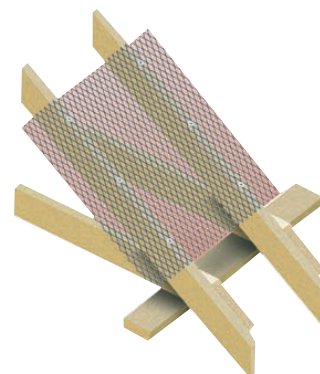

MD1



HD1&MD1

◀ **METAL STUD WALLS, PURLINS & ROOFS**

Securilath fixed to metalwork with No 6 or 8 x 30 zinc plated self tapping screws, complete with 25mm dia x 1.5mm galvanised washers fixed at maximum 450mm centres.

► **BRICK OR BLOCKWORK APPLICATIONS**

Suitable for both render and plaster finishes. Securilath HDR mesh fixed with either suitable shot fired mixing, or plug and M6 x 50mm screw and plug, complete with minimum 25mm dia x 1.5mm galvanised washers at max 450mm centres.

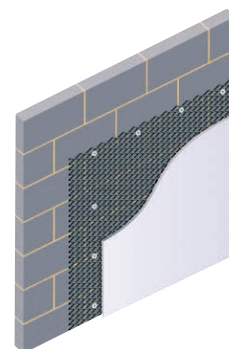

HDR

FACING FIXINGS

We suggest that plasterboard facing is fixed onto Securilath and stud using bugle head drywall screw fixings PN2 3.5x55 BZP at maximum 450mm centres.

Plywood should be fixed using 4.5mm x 50mm BZP or passivated wood screws at maximum 450mm centres.

Whilst every effort has been made to ensure the accuracy of the information supplied. F.H. Brundle cannot be held responsible for any errors or omissions. This product must only be employed for its original intended use. Any other use is wrong and potentially dangerous. Installation must be carried out in full compliance with current regulations. F.H. Brundle cannot be held liable for any damages resulting from wrongful, erroneous or negligent use.

Southampton

Tel: 023 8070 3333

Fax: 023 8070 5555

Rainham

Tel: 01708 25 35 45

Fax: 01708 25 35 50

Ilkeston

Tel: 0115 930 2070

Fax: 0115 951 2455

Birmingham

Tel: 0121 565 8282

Fax: 0121 565 8292

Haydock

Tel: 01942 86 88 88

Fax: 01942 86 88 99

Glasgow

Tel: 0141 773 6699

Fax: 0141 773 6633



F.H. BRUNDLE
SERVING THE TRADE SINCE 1889

www.fhbrundle.co.uk
sales@brundle.com